

# Kingsdale Lodge

The Kingsdale is Pemberton's flagship park home and is popular with an optional appealing CanExel and Stucco exterior, bay windows in a choice of 4 different colours and dual entrances with an open sight line from the hallway to the utility area. This home has been designed to free flow from one room to another but with the option to have a closed off lounge and a door from the hallway to the kitchen/utility.

PLATINUM

Image shows 40x20 2 bed



Pemberton Kingsdale 40 x 20 2 bed Platinum shown in optional Canexel Cladding & Stucco with optional Anthracite Windows & Doors



With a eye-catching mirrored splashback to the utility the large work surface is perfect for mixing cocktails for your guests. Both bedrooms have king size beds and stunning wardrobes complete with internal drawers and there is a walk through vanity area linking the en-suite to the master bedroom. Colours are elegantly neutral throughout, with a pop of burgundy in the lounge, and calming blue to the bedrooms.

PLATINUM

Image shows 40x20 2 bed



### Highlights

- PVCu double glazing with bay windows
- Gas combi central heating system with thermostatic radiator valves
- TV points in both bedrooms
- Integrated washer/dryer, dishwasher and microwave
- Downlit fireplace with electric stove
- Luxurious lounge suite and storage footstool
- Utility room with rear door access
- 5ft upholstered divan in the master bedroom and second bedroom with drawers for storage
- External socket
- Wireless thermostat
- Grain Effect Plastic Cladding
- Lounge Scatter Cushions
- Bedroom Throws and Co-ordinating Scatter Cushions
- Duvet Sets
- High level cooker with separate oven and grill
- Kitchen Plinth Ambient lighting

40ft x 20ft

2 bedroom

44ft x 20ft

3 bedroom



PLATINUM

Image shows 40x20 2 bed



PLATINUM

Image shows 40x20 2 bed



PLATINUM

Image shows 40x20 2 bed



PLATINUM

Image shows 40x20 2 bed



# Kingsdale Lodge

## Platinum Package Option includes the following:













- Aggregate Coated Steel Tile System with a 40 Year Weatherproof Warranty
- Wood effect Panelled Ceiling
- Wallpaper Finish
- Domestic Skirting and Door Casings
- Electric Combination Safe
- Hive Heating System
- Wine Cooler
- Bluetooth Speakers
- Outdoor Tap

## Residential Specification

### Option includes the following:

- Roof 250mm insulated
- 125mm thick wall
- Floor minimum 120mm insulated
- Windows low E glass and Argon filled
- Superior Insulation U values exceeding the British Standard

### Key

- |   |   |
|---|---|
|    |    |
|    |    |
|   |   |
|  |  |
|  |  |
|  |  |
|  |  |



40ft x 20ft - 2 bedroom

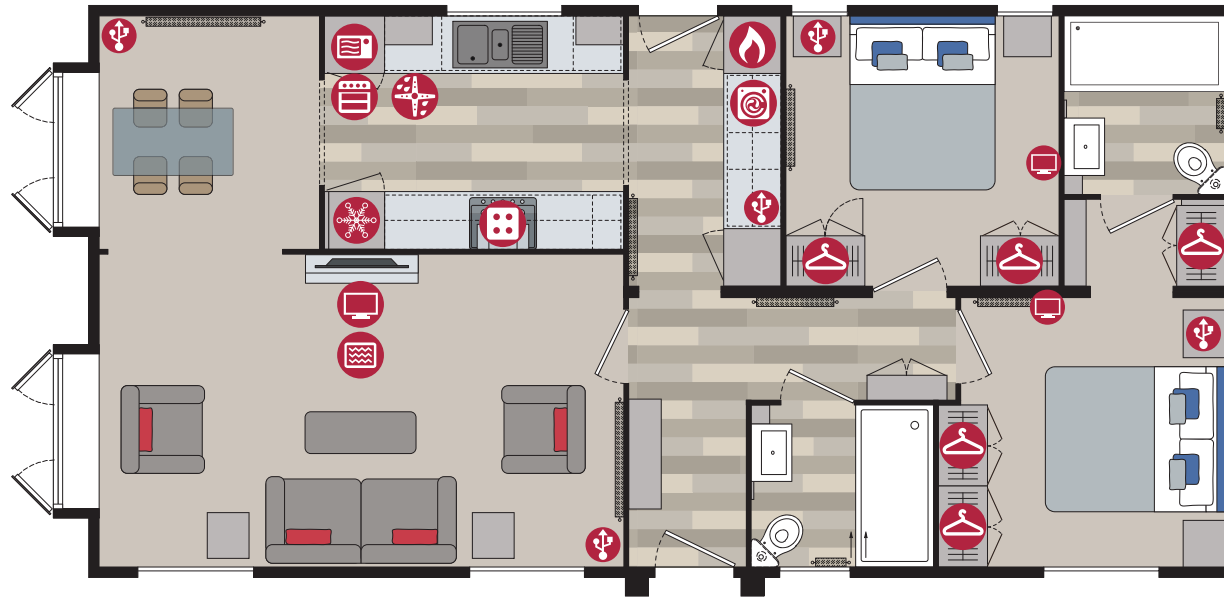

44ft x 20ft - 3 bedroom

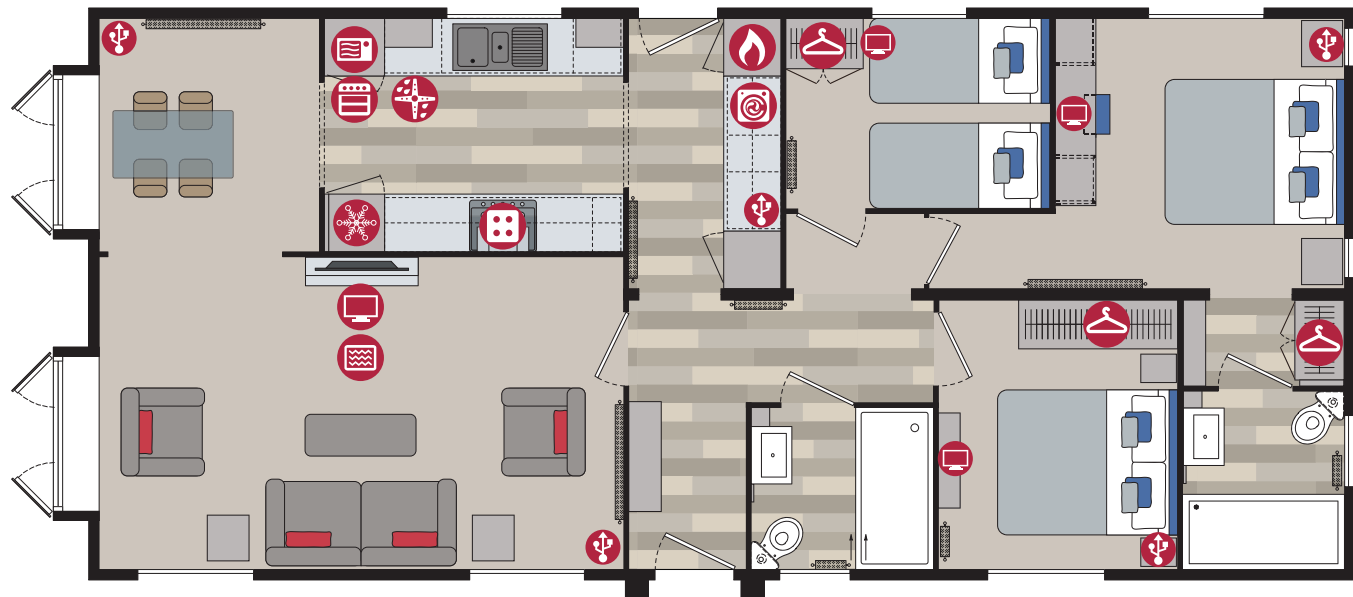

PLATINUM

Image shows 40x20 2 bed



PLATINUM

Image shows 40x20 2 bed



PLATINUM

Image shows 40x20 2 bed



PLATINUM

Image shows 40x20 2 bed



### Options available to order

- Residential Specification to BS3632 available in all cladding types
- Patio doors to front elevation
- Wine cooler
- Closed off lounge
- Bath in lieu of shower
- Platinum Package
- Kingsdale Lodge available in Canexel, Stucco & Vinylit Cladding
- Lift up storage bed
- All electric version including central heating

For further details see standard features checklist on pages 76-77.



**Pemberton**  
PARK & LEISURE HOMES